

N-box

*in-wall installation
technique*

*N-solutions of universal
in-wall faucets*

New

Patented
technique

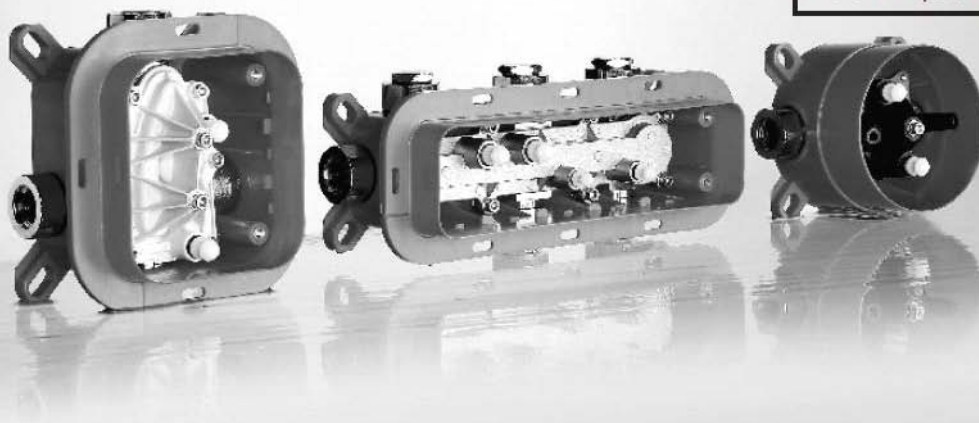

“Have seen in-wall faucets
Never seen so nicely embedded type!”

12 reasons for your definite selection of N-box!

1. Small sizes and thin in-wall portion.
2. It can be easily installed in hollow or solid walls.
3. The In-wall box has 25 mm adjustable space, and dedicated height-raised panel realizes 18mm free overlaying.
4. Two-step installation: the decoration process does not involve the control valve and naked parts installation, prevents scratch or loss; faucet keeps new in your use.
5. Single functions e.g. portable shower, top shower, downward nozzle, acupuncture or freely combined shower solutions can be provided.
6. Super-high flow technique provides optimal shower experience.
7. The embedded body is universal, and user can choose configuration or function combinations according to personal favor and purchasing power.
8. Impurities inside pipe can be flushed out, and pipe air-tightness and pressure durability can be tested in advance to ensure no pipe blockage or leakage at the wall.
9. Valve core is not tested, and maintenance needs no wall demolition and no damage of valve core; dedicated air bag can relieve water pressure, protect valve core and extend the service life of core and main body.
10. A plastic panel is designed to prevent water residue from leaking into the control valve, keeping dry and long service life.
11. Cost and stock can be reduced, and less expense and time are required in case of restructuring and re-installation in the future.
12. Uncertain factors that may cause work defects or reworking, e.g. design, pipe arrangement, equipment configuration can be reduced, and both arrangement and design can be temporarily changed.



Embedded box

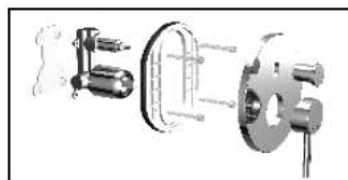

Two-function control valve



In-wall shower faucet

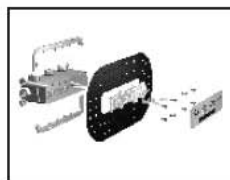

Multi-functional embedded box

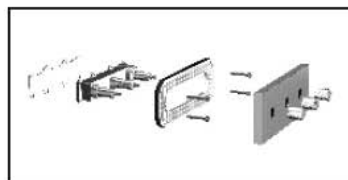

Multi-functional main body



In-wall multi-functional valve

N-box

Universal

Diagram of N-box function combinations

5 Single-handle in-wall basin faucet

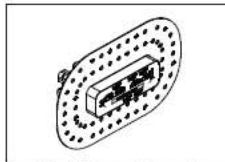

Multifunctional changeover box

+

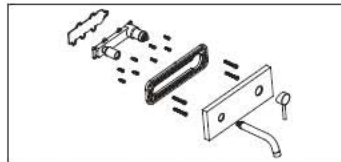

Control valve of single-handle in-wall basin faucet

=

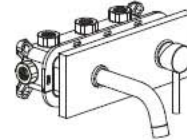

6 Two-handle in-wall basin faucet

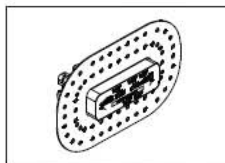

Multifunctional changeover box

+

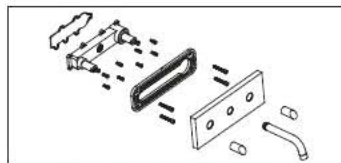

Control valve of two-handle in-wall basin faucet

=

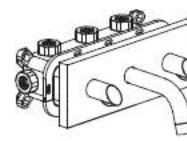

7 Two-handle single-function shower faucet

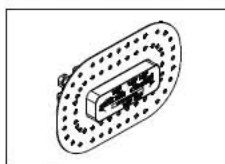

Multifunctional changeover box

+

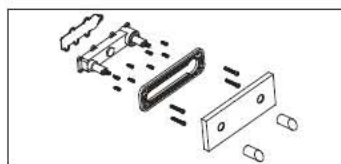

Two-handle single-function shower control valve

=

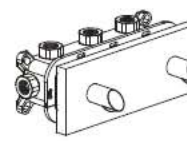

8 Two-handle single-function shower faucet

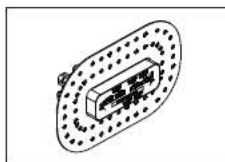

Multifunctional changeover box

+

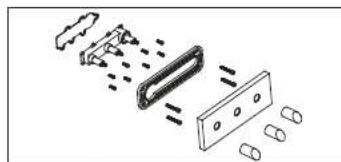

Two-handle two-function shower control valve

=

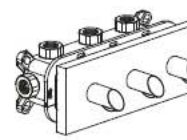

9 Ground bathtub faucet



N-box

+

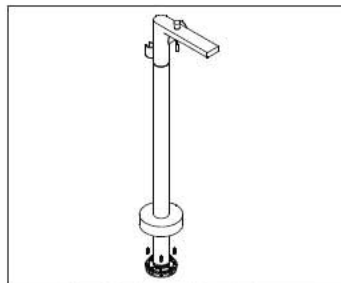

Single-handle deluxe ground bathtub valve

=

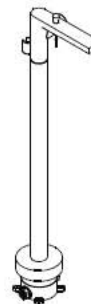

N-box Universal

N-solutions of exclusive universal in-wall faucets

N-box valve core is the most ideal base for the installation of in-wall faucets, applicable for all types of ABM in-wall faucets, and can be easily replaced even after years of use. It then makes installation of in-wall faucets easy and free for desired positions.

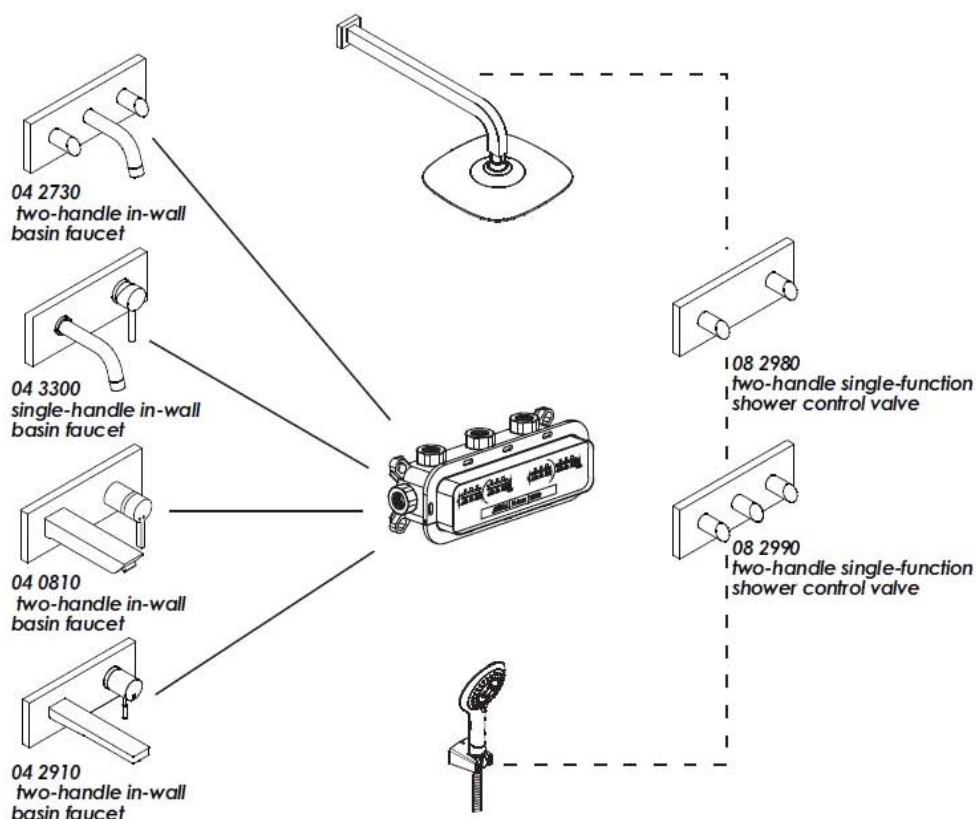

Personalized combinations can be realized according to your favors

To achieve comfortable whole-body shower, you can have flexible combinations of top shower, portable shower, control valve, nozzle, outlet holder and even shower holder if you like. Each part is of course ABM high-quality product, and then their combinations are definitely superior. Simply selecting any series, you can change your shower devices into a complete shower center, offering you all-sided service and dynamic shower experience.

Steps for installation of single-handle in-wall washbasin faucet control valve

1 Exploded view of single-handle in-wall washbasin faucet control valve

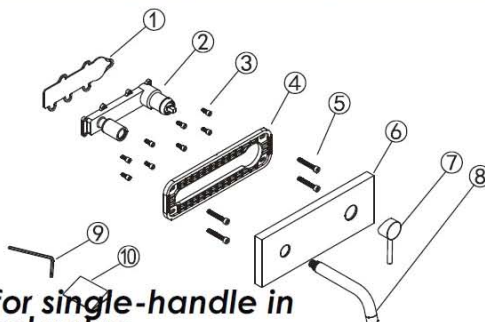

List of standard accessories for single-handle in-wall washbasin faucet control valve

S/N	Description	Qty.	S/N	Description	Qty.
①	Bottom baffle	1	⑥	Decorative panel	1
②	In-wall main body	1	⑦	Handle	1
③	Round-head hexagonal screw	8	⑧	Outlet pipe	1
④	Plastic panel	1	⑨	SW=4 hex wrench	1
⑤	5 x 45 hexagonal screw	4	⑩	User Manual	1

2 Steps for installation of single-handle in-wall washbasin faucet valve

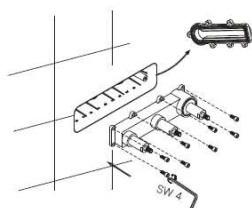

1. Take out the water test device from the N-box body, connect the one-handle single-function control valve to the N-box body and fasten them with screw.

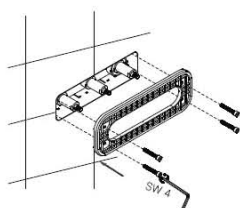

2. Fasten the plastic panel and the N-box with screw.

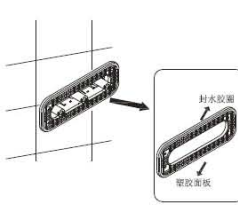

3. Prevent water from leaking into the wall (a sealing rubber ring is provided on the plastic panel).



4. Fix the decorative panel and the handle to complete the erection.

3 Instructions of single-handle in-wall washbasin faucet valve

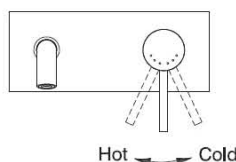
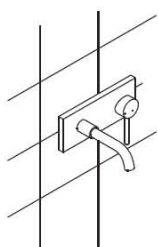

1. Turn on the control handle, mixed water is drained; turn the handle left to drain more hot water or turn right to drain more cold water.

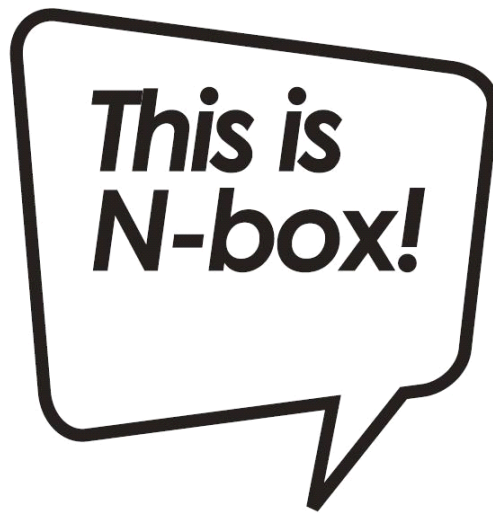

Easy! N-box!